

Features	
Design	Pneumatically actuated pinch valve
Sealing principle	Elastic lip seal
Mounting position	Any
Type of mounting	In-line installation
Direction of flow	Reversible
Valve function	2/2 way, normally open
Reset method	Rebound resilience
Nominal pressure	PN10
Sleeve feature	Replaceable



Technical data	
Pressure difference [bar]	2.5.....3
Medium pressure [bar]	0.....5.5
Max control pressure [bar]	8.5
Working temperature [°C]	-10.....+70
Optimum control pressure	Medium pressure+Pressure difference+0.5
Surface treatment	Sand blasting with original color anodizing
Certificate	EN45545 HL3

### Advantage

- \* Compact design
- \* Free passage
- \* No plugging
- \* 100% shut off
- \* Easy maintenance
- \* Quick open-close

### Application

For vacuum toilet

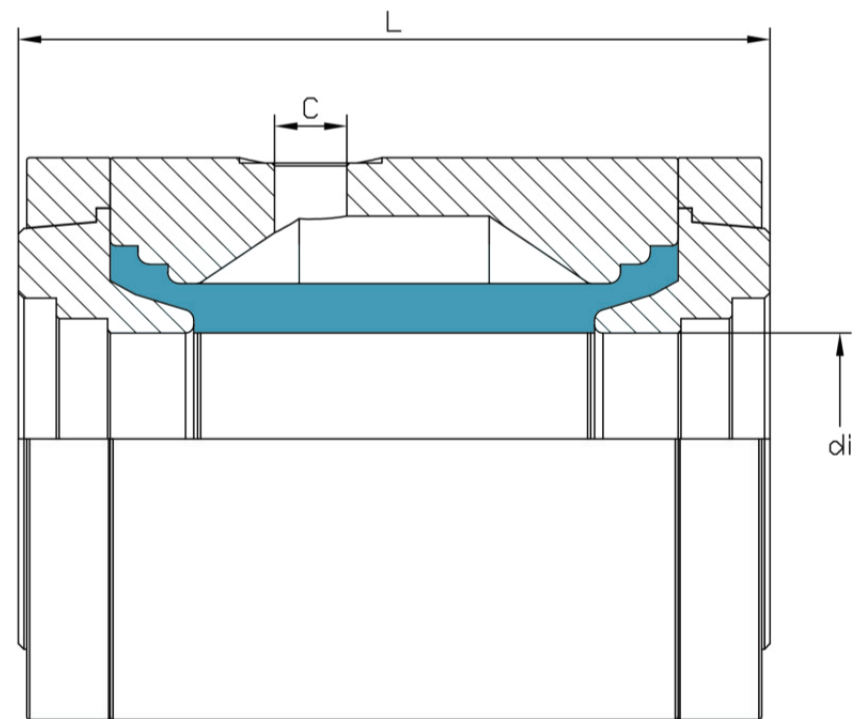
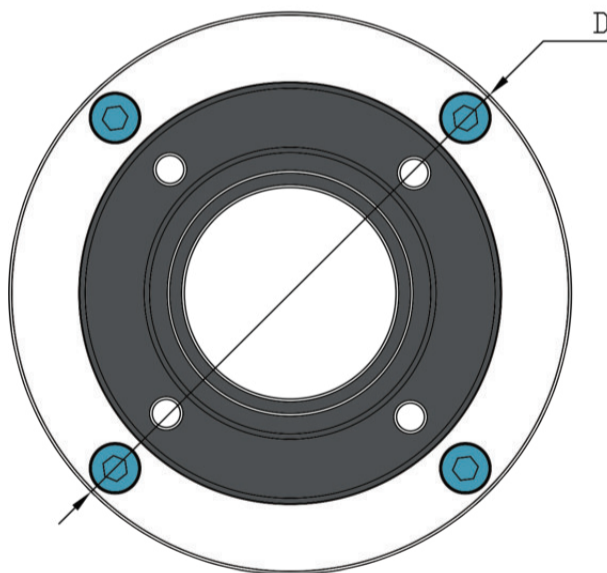

DN (mm)	di (mm)	L (mm)	D (mm)	C	Vol.l	Weight(KG)
40	38	135	101	G 1/4"	0.23	1.7